

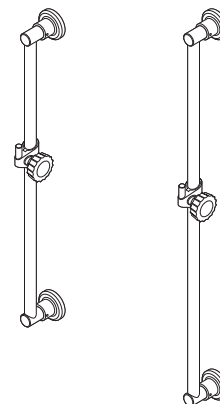

72632

INSTALLATION INSTRUCTIONS FOR ADJUSTABLE WALL BAR

Models
55024▲ & 55030▲
Series



Write purchased model number here.
Escriba aquí el número del modelo comprado.

▲ Designate proper finish suffix

The installation of your new Delta® adjustable bar unit is simple and easy requiring no special tools or skills. Caution: Use care to avoid marring or scratching chromed and plastic surfaces. A personal shower offers numerous possibilities of connections to water supply. The hose will connect easily to the shower arm, elbow at the shower outlet, Delta® shower diverter (permitting existing shower to remain in use), or Delta®

diverter tub spout (permitting this shower to be added to baths without a shower). It is important to establish your water supply connections first, as this avoids mounting the bar too far from the water supply outlet, creating excessive strain on flexible hose. As subsequent instructions specify, the bar should be mounted in a vertical position at the most convenient height.

Conversion of Water Supply

Conventional Water Supply For wall shower/hand shower use.

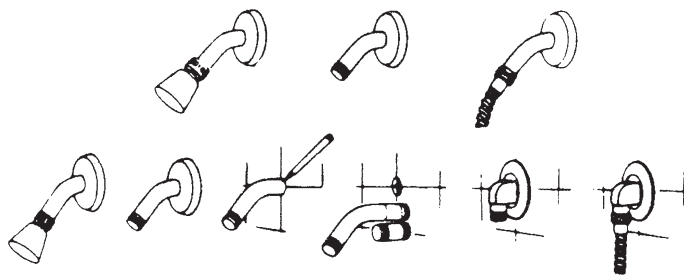

- Installation:
1. Remove existing shower head from shower arm.
 2. Attach flexible hose to exposed threads on shower arm using gasket.

- Installation:
1. Remove existing shower head and escutcheon from shower arm.
 2. Mark shower arm at wall and remove shower arm replacing it with a nipple 1/2 inch longer than unexposed length of shower arm to the mark.
 3. Attach Delta® supply elbow with flange onto nipple and tighten securely.
 4. Attach hose to supply elbow using gasket provided.
- Caution: Do not twist supply pipe in wall.**

Shower Diverter Water Supply For use with existing shower.



- Installation:
1. Remove shower head by turning counter clockwise.
 2. Attach female threaded end of shower diverter to shower arm, using gasket supplied. Do not overtighten.
 3. Replace shower head onto end of diverter shower. A sealant such as pipe compound or plumber tape may be required to prevent water seepage.
 4. Attach flexible hose to shower diverter using gasket supplied. Do not overtighten.

Tub Spout Water Supply For baths without shower.



- Installation:
1. Remove present tub spout by turning counter clockwise.
 2. Replace with Delta® diverter tub spout following directions enclosed inside package.

Hose Care

Your hose is of high quality chrome plated spiral wound around a rubber inner liner. It will provide many years of quality performance with proper care. Avoid the following conditions which may weaken or damage your hose and void your warranty.

Do not pull, strain, stretch, or jerk hose.

Do not wind, twirl or twist hose.

Do not bend, knot, coil or crimp hose.

72632

Select Location

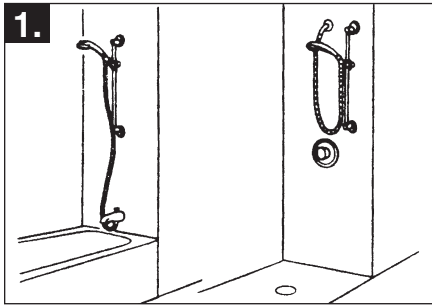

1. Your bar unit is a beautiful bath accessory and should be located so it looks good and performs as intended. Pictured are some typical installations as suggestions only, pick a location that suits your family's needs.

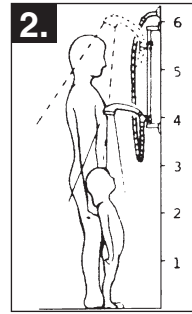

2. Select a convenient height based on your family's needs. **Note:** Locate so there will be slack in the hose when shower is in extreme up or down position.

Mounting Bar

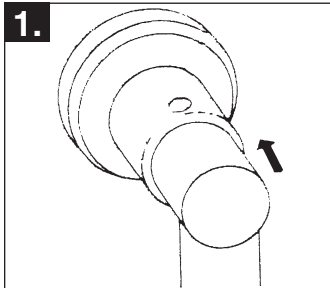

1. Place end mount of wall bar into the mount - do not tighten the set screw.

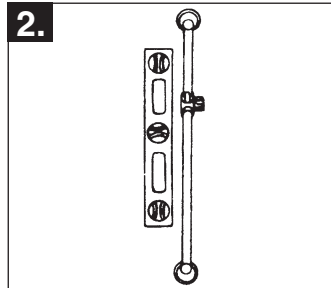

2. Position bar on wall at desired position.

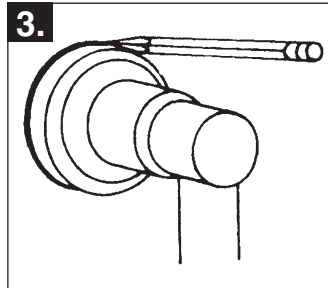

3. Draw circle around top mount with soft pencil.

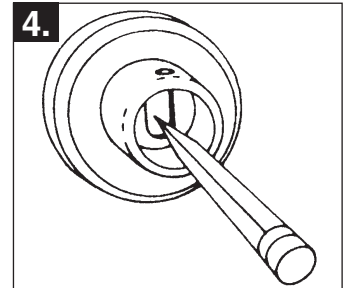

4. Remove bar mount from bar. Place in marked position on wall and mark center screw hole on wall. Do not mark lower mount at this time.

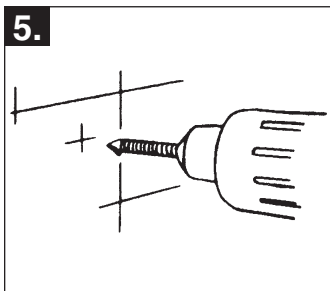

5. Drill hole for top mount. Use 1/4 inch carbide drill for ceramic tile.

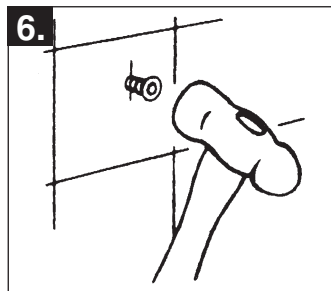

6. Insert screw anchor.

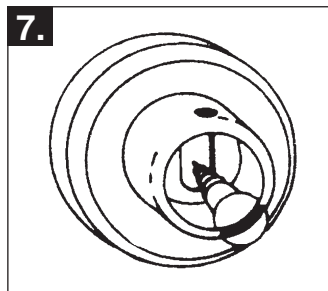

7. Secure mount to wall with screw. **Note:** Allen set screw must be at top of mount.

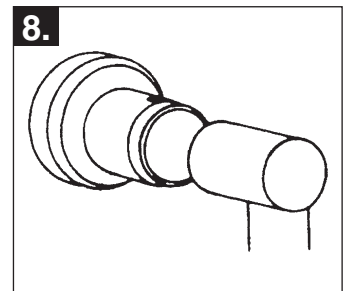

8. Place bar into mount. Do not tighten Allen set screw.

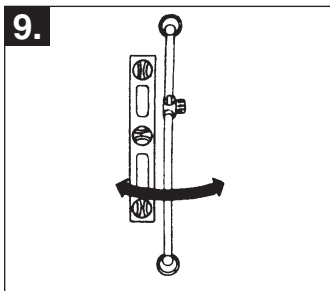

9. Align bar and mark bottom as in step 5.

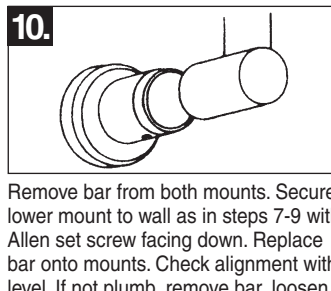

10. Remove bar from both mounts. Secure lower mount to wall as in steps 7-9 with Allen set screw facing down. Replace bar onto mounts. Check alignment with level. If not plumb, remove bar, loosen mount screws and adjust accordingly, retighten screws and replace bar.

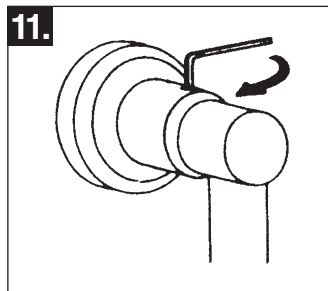

11. Tighten Allen set screw on both top and bottom mounts.

CAUTION:
Delta® Wall Bars are not to be used as grab bars!

LIFETIME FAUCET AND FINISH LIMITED WARRANTY

All parts and finishes of the Delta® faucet are warranted to the original consumer purchaser to be free from defects in material & workmanship for as long as the original consumer purchaser owns their home. Delta Faucet Company recommends using a professional plumber for all installation & repair.

Delta will replace, FREE OF CHARGE, during the warranty period, any part or finish that proves defective in material and/or workmanship under normal installation, use & service. Replacement parts may be obtained by calling 1-800-345-DELTA (in the U.S. and Canada) or by writing to:

In the United States:
Delta Faucet Company
Product Service
55 E. 111th Street
Indianapolis, IN 46280

In Canada:
Masco Canada Limited, Plumbing Group
350 South Edgeware Road,
St. Thomas, Ontario, Canada N5P 4L1

This warranty is extensive in that it covers replacement of all defective parts and even finish, but these are the only two things that are covered. LABOR CHARGES AND/OR DAMAGE INCURRED

IN INSTALLATION, REPAIR, OR REPLACEMENT AS WELL AS ANY OTHER KIND OF LOSS OR DAMAGES ARE EXCLUDED. Proof of purchase (original sales receipt) from the original consumer purchaser must be made available to Delta for all warranty claims. THIS IS THE EXCLUSIVE WARRANTY BY DELTA FAUCET COMPANY, WHICH DOES NOT MAKE ANY OTHER WARRANTY OF ANY KIND, INCLUDING THE IMPLIED WARRANTY OF MERCHANTABILITY.

This warranty excludes all industrial, commercial & business usage, whose purchasers are hereby extended a five year limited warranty from the date of purchase, with all other terms of this warranty applying except the duration of the warranty. This warranty is applicable to Delta® faucets manufactured after January 1, 1995.

Some states/provinces do not allow the exclusion or limitation of incidental or consequential damages, so the above limitation or exclusion may not apply to you. Any damage to this faucet as a result of misuse, abuse, or neglect, or any use of other than genuine Delta® replacement parts WILL VOID THE WARRANTY.

This warranty gives you specific legal rights, and you may also have other rights which vary from state/province to state/province. It applies only for Delta® faucets installed in the United States of America, Canada, and Mexico.